

◆ **Shape/外觀:**



◆ **Specifications /規格表:**

Catalog Listing / 型號	MT-PK3-1707
Description / 檢出方式	Through beam / 對照式
Sensing distance / 檢出距離	5M
Output method / 輸出模式	NPN.NO
Response time / 反應時間	1.5 ms Max.
Light emitter / 發光源	660 nm.
Operating voltage / 工作電壓	DC: 12 ~ 24 VDC
Current consumption / 消耗電流	40 mA Max.
Output current / 輸出電流	24 VDC 100mA max.
Insulation resistance / 隔離阻抗	20M Ω Min. 500VDC
Dielectric strength / 絕緣耐壓	1000VAC for 1min.
Ambient humidity / 工作溼度範圍	35%~85% RH
Weight / 重量	Approx 110g
Operating temperature/工作溫度範圍	- 20 °C ~ + 60 °C
Housing material / 外觀材質	ABS
Wiring method / 出線方式	Receiver: $\phi 4.2 \times 2$ M / 4-cores Emitter: $\phi 4.2 \times 2$ M / 3-cores
Protection degree / 防水等級	IP64

◆ **Dimensions/尺寸圖:**

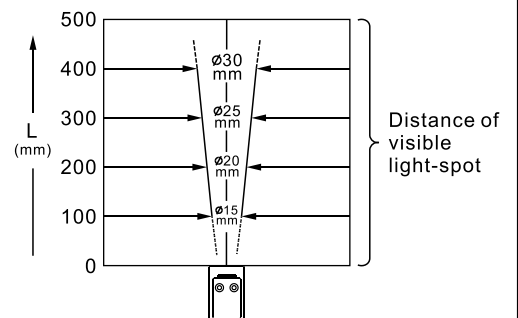
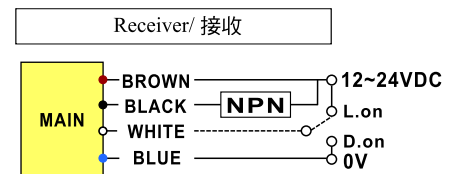
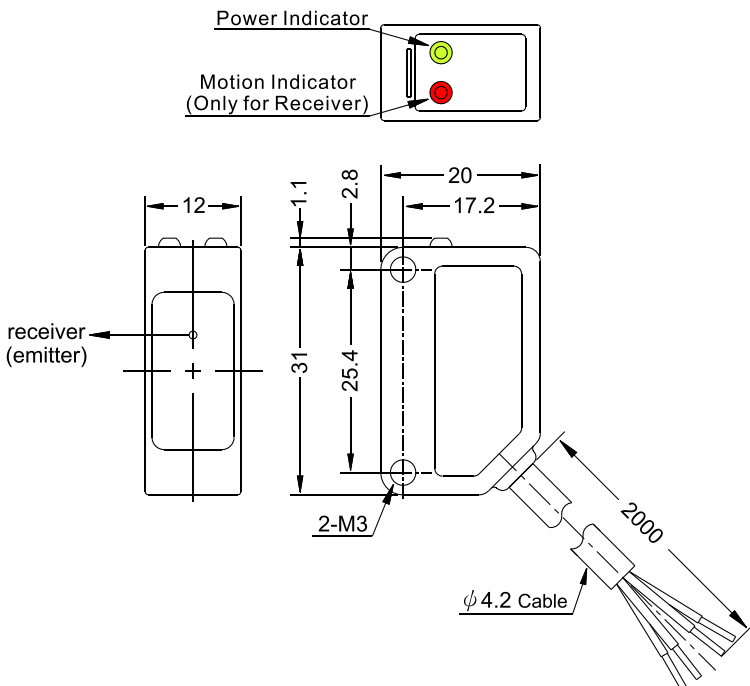

◆ MT-PK3-1707 max deviation

X	RX POS 1	RX POS 2	RX POS 3
50 CM	16 MM	0	16 MM
70 CM	25 MM	0	25 MM
80 CM	30 MM	0	30 MM
90 CM	34 MM	0	34 MM
100 CM	38 MM	0	38 MM
110 CM	42 MM	0	42 MM
120 CM	45 MM	0	45 MM
130 CM	47 MM	0	47 MM
140 CM	50 MM	0	50 MM
150 CM	53 MM	0	53 MM
160 CM	56 MM	0	56 MM
170 CM	60 MM	0	60 MM
190 CM	64 MM	0	64 MM
200 CM	67 MM	0	67 MM

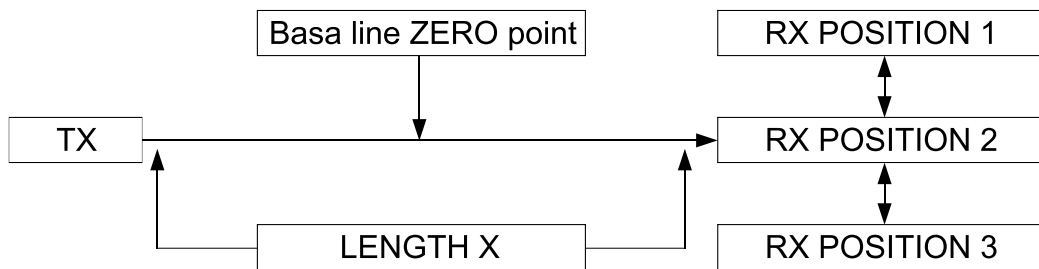

RX POSITION 2 — is just to make shore the sensor is function ok.

RX POSITION 1 — is to determine what is the tolerance above the base line (in mm or what is the max angle between the base line and the RX sensor) that the unit is still working ok.

RX POSITION 3 — is the same as to only below base line.

X(cm)	RX POS 1(mm)	RX POS 2(mm)	RX POS 3(mm)
0	0	0	0
50	-16	0	16
70	-25	0	25
80	-30	0	30
90	-34	0	34
100	-38	0	38
110	-42	0	42
120	-45	0	45
130	-47	0	47
140	-50	0	50
150	-53	0	53
160	-56	0	56
170	-60	0	60
190	-64	0	64
200	-67	0	67

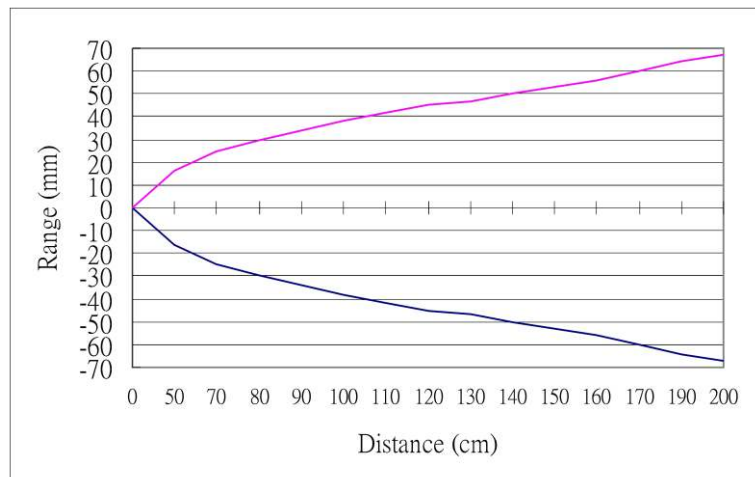

◆ Accessories/配件:

• MT-8808

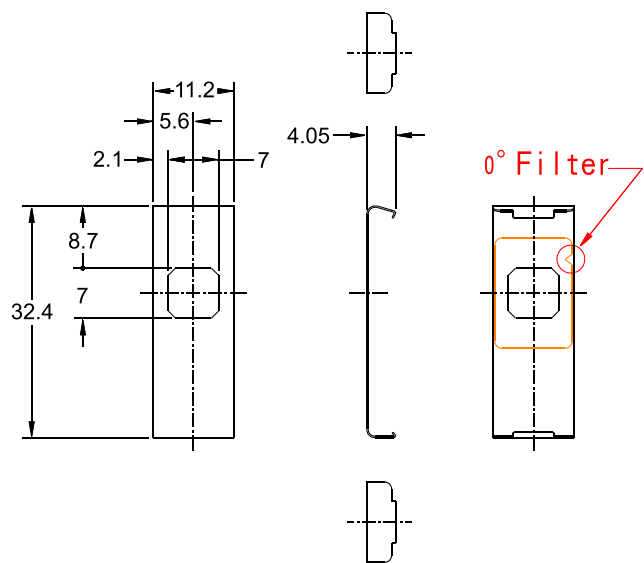

• MT-88081

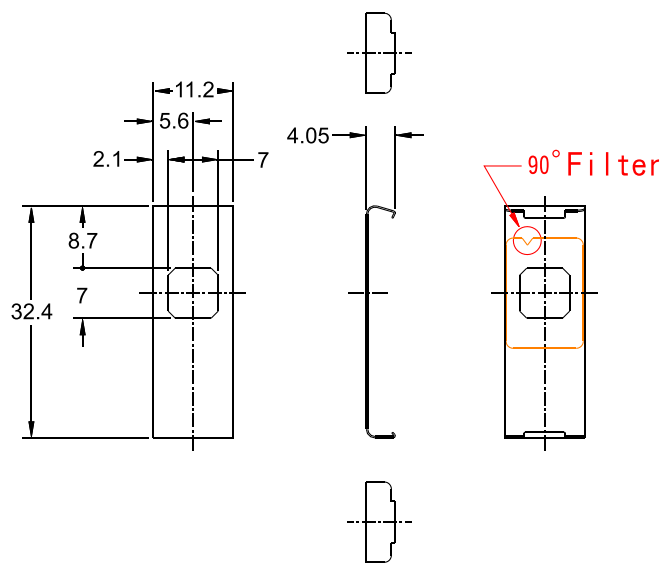

◆ How to mount the filter/安裝方法:

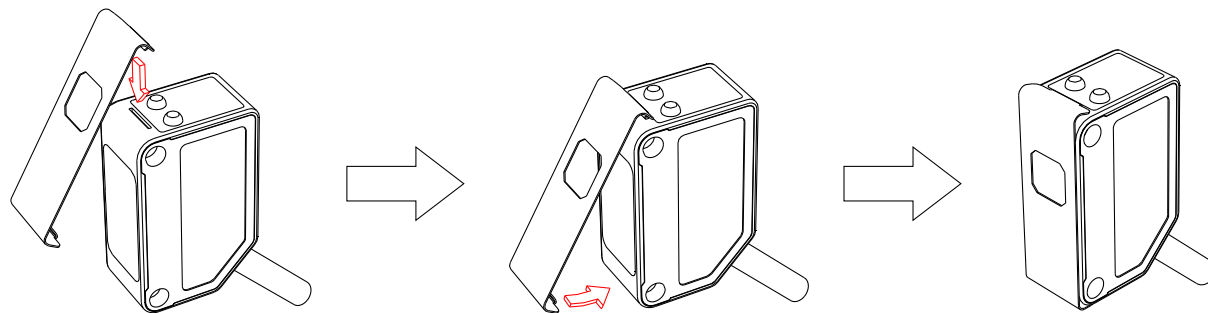
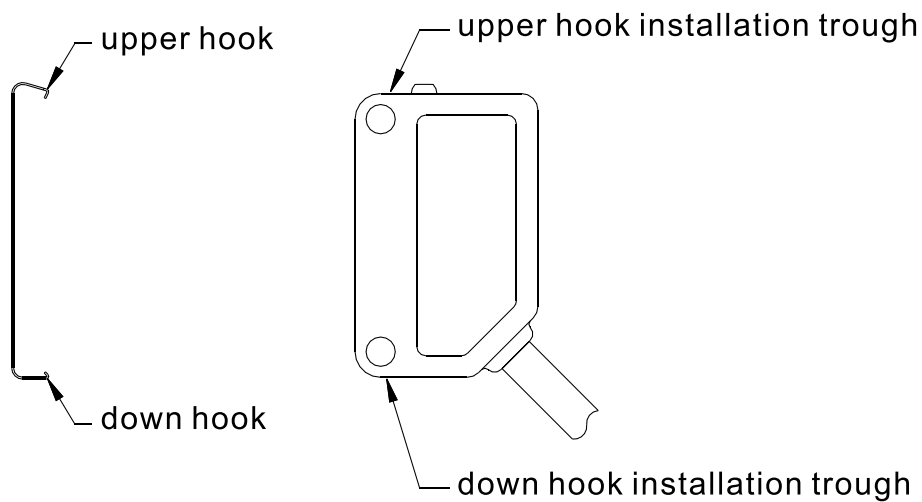

1. Fit the upper hook onto the upper hook installation trough and keep parallel direction with the front surface of the sensor.

2. Fit the down hook onto the down hook installation trough.